

# INSTALLATION INSTRUCTIONS C-HDM-222

## Internal HDM pole mount for C-VS-0618-INUT console

### TOOLS REQUIRED:

Standard socket set

T-20 Torx driver

7/16" & 1/2" wrench

### **PARTS and MOUNTING HARDWARE:**

<u>QTY</u>	<u>DESCRIPTION</u>	<u>PART#</u>
1	HDM top plate	CM009780
2	Half-moon HDM cover	CM009992
2	Extrusion spacer	CM009998
2	Extrusion bracket	CM009999
2	7" Extrusion	CM93535-40
1	5.5" to 8.375" HDM pole	C-HDM-208
1	Front lower mounting bracket	CM010109
1	Rear lower mounting bracket	CM010110
1	HDM lower mounting plate	CM010111
4	#8-18 x 1/4" Phillips flat head screws	GSM33178
4	1/4" x 1/2" carriage bolts	GSM31999
4	1/4" Serrated nuts	GSM30023
8	#8 x 3/8" Torx screws	CM86508
1	Switch blank	C-SW-B
1	7/8" Plug	CM86430
1	Hardware kit	C-HK-102
	<u>C-HK-102 includes:</u>	
4	5/16-18 X 3/4" Hex head bolt	GSM33011
4	5/16" Flat washer	GSM31006
4	5/16" Lock washer	GSM31027

### **Always!**

- Read all instructions before installing any Havis, Inc. products.
- **Check for obstructions (Wires, brake lines, fuel tank, etc.) before drilling any holes!**
  - Use hardware provided with install kit

## C-HDM-222

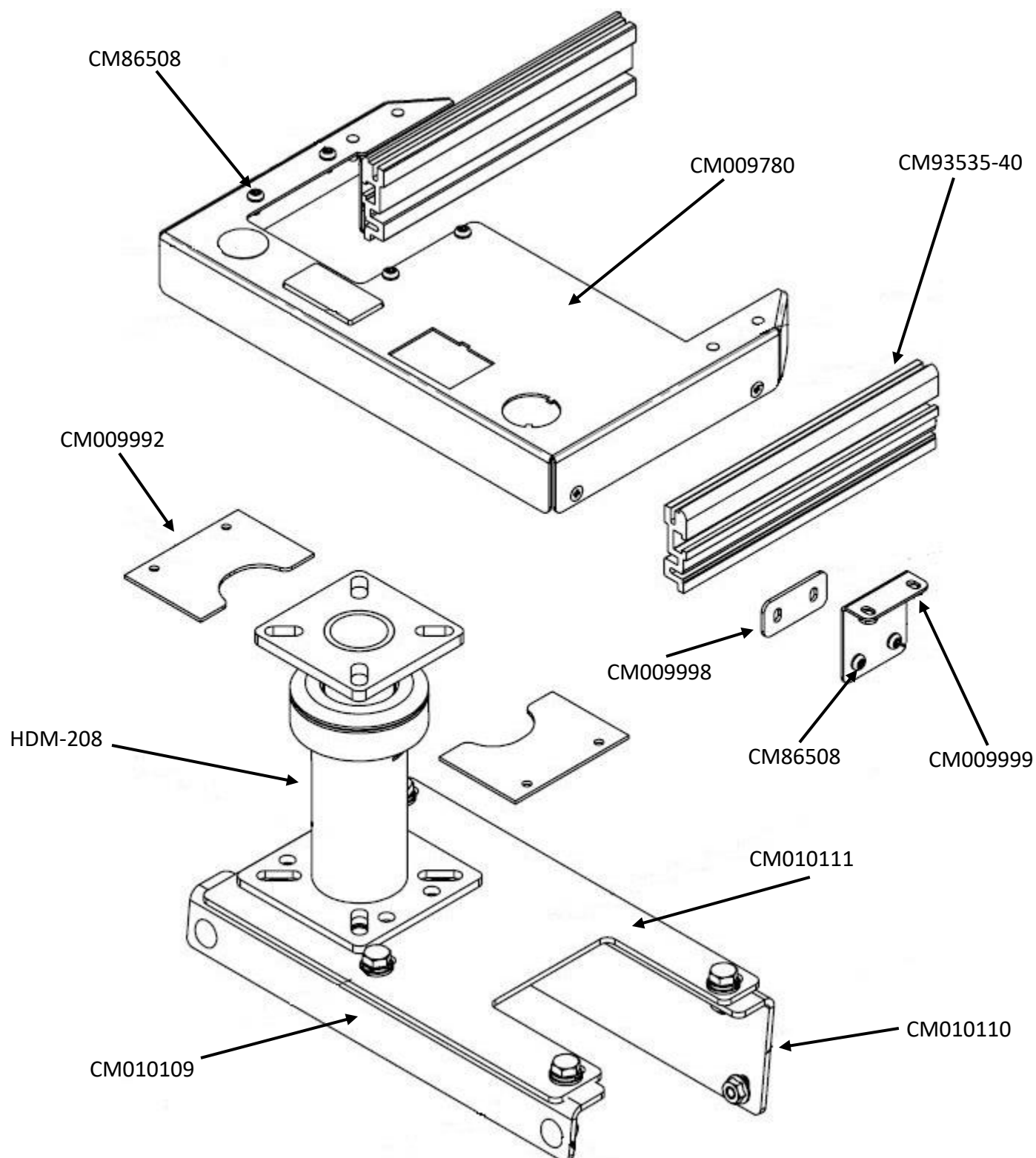



Install cross front and rear cross brace to side mounting brackets using (4) 1/4" x 1/2" carriage bolts and serrated nuts.

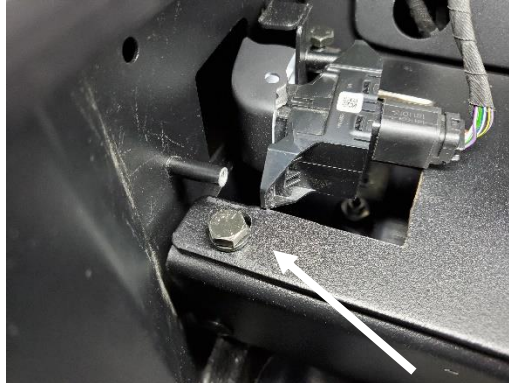

Attach mounting platform to cross braces using (4) 5/16 x 3/4" bolts, split lock washers and flat washers. Attach emergency brake release to side of console.



Attach HDM pole to platform using (4) 5/16" x 1" bolts, split lock washers and flat washers included with pole mount kit.

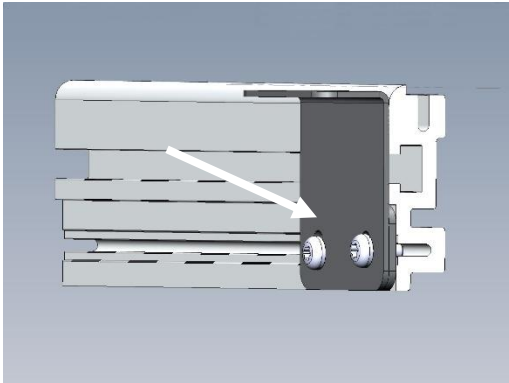

Attach console extrusion bracket and spacer to extrusion using two (2) #8 x 3/8" Torx screws. **Be sure to line up to edge of extrusion.**

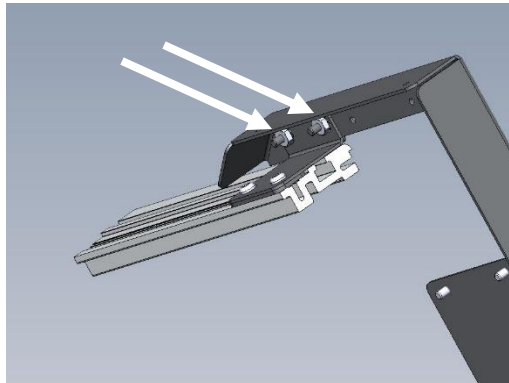

Attach extrusion and bracket assembly to HDM top plate studs using 8-32 Keps nuts. **Repeat bracket mounting on other side.**



Place assembled HDM top plate onto console and line up to side screw holes in console housing.



Attach top plate using #8-18 x 1/4" Phillips flat head screws.



Using (4) #8 x 3/8" Torx screws, attach half-moons to top of HDM plate.



HDM pole mount kit installation is now complete. Proceed with installation of wiring, controls and accessories.